

WALPOLE PARK SOUTH | WALPOLE, MA
OFFICE/FLEX/WAREHOUSE BUILDING FOR LEASE
BUILDING 1 UNIT 10



For Lease
13,328 SF
Office/Flex/Warehouse Space

contact information



Commercial Real Estate Services, Worldwide.

All information furnished regarding property for sale or lease is from sources deemed reliable, but no warranty or representation is made as to the accuracy thereof and same is submitted subject to errors, omissions, change of price, rental or other conditions prior to sale or lease, or withdrawal without notice.

Cathy Minnerly, Executive Vice President | 617 457 3334 | cminnerly@naihunneman.com

Ovar Osvold, Associate | 617 457 3222 | oosvold@naihunneman.com

303 Congress Street | Boston, MA 02210 | 617 457 3400 | www.naihunneman.com

WALPOLE PARK SOUTH | WALPOLE

Available for Lease

BUILDING SPECIFICATIONS:

Total Square Feet:	105,000 SF	Power:	1-200 amps (277/480 volt) 3 phase 1-400 amps (120/208 volt) 3 phase
Available SF:	13,328 SF	Utilities:	Gas: Baystate Electricity: Boston Edison
	Office: 4,855 SF Warehouse: 8,473 SF	Sewer/Water:	Town of Walpole
Land Area:	8.6 Acres (54 Acres in Park)	Sprinklers:	Wet System
Ceiling Height:	16' Clear	Roof:	Conventional Rubber Roof
Loading:	1 drive in, 1 tailboard	Real Estate Tax	
Zoning:	Limited Manufacturing	& Cam:	\$1.65 (FY 2010)
Construction Type:	All block construction	Occupancy:	Immediate
Air Conditioning:	Fully air conditioned	Lease Rate:	\$6.95 psf NNN
Parking:	Ample	Location:	Located on Route 1 approx. 1 mile off I-95
Column Spacing:	34' x 43'		



WALPOLE PARK SOUTH | WALPOLE

13,328 SF Available For Lease

BUILDING 1 FLOOR PLAN

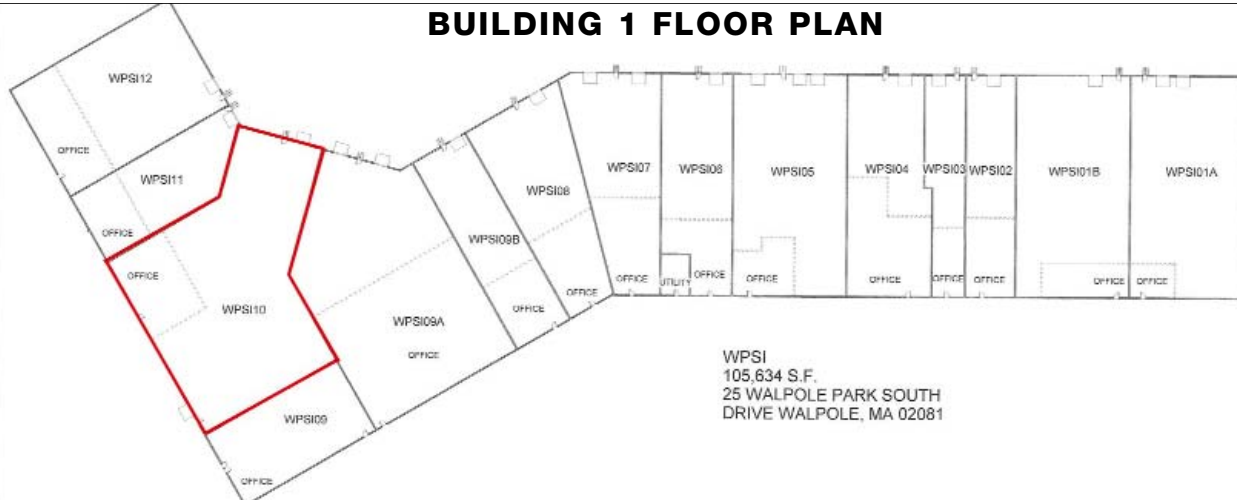

UNIT FLOOR PLAN

