

# WALPOLE PARK SOUTH | WALPOLE, MA

## OFFICE/FLEX BUILDING FOR LEASE

### BUILDING 5 UNIT 1



## Office/Flex Space For Lease

18,990 SF with  $\pm 10,000$  SF Expansion Capability

### contact information

Cathy Minnerly, Executive Vice President | 617 457 3334 | [cminnerly@naihunneman.com](mailto:cminnerly@naihunneman.com)

Ovar Osvold, Associate | 617 457 3222 | [osvold@naihunneman.com](mailto:osvold@naihunneman.com)

303 Congress Street | Boston, MA 02210 | 617 457 3400 | [www.naihunneman.com](http://www.naihunneman.com)



Commercial Real Estate Services, Worldwide.

All information furnished regarding property for sale or lease is from sources deemed reliable, but no warranty or representation is made as to the accuracy thereof and same is submitted subject to errors, omissions, change of price, rental or other conditions prior to sale or lease, or withdrawal without notice.

# WALPOLE PARK SOUTH | WALPOLE

## Available for Lease

### BUILDING SPECIFICATIONS:

Total Square Feet:	30,000 SF	Power:	1,000 amp, 277/480 Volt, 3 phase, 4 wire
Available SF:	18,990 SF	Utilities:	Gas: Columbia Gas
	Office: 11,990 SF		Electricity: NStar
	Flex: 7,000 SF		Sewer/Water: Town of Walpole
Land Area:	2.93 Acres (54 Acres in Park)	Sprinklers:	Wet System
Ceiling Height:	10' Clear (Office) 14'-16' Clear (Flex)	Roof:	Conventional Rubber Roof
Loading:	2 tailboard docks	Real Estate Tax	
Zoning:	Limited Manufacturing	& Cam:	\$1.17/1.02- \$2.17 (FY 2011)
Construction Type:	All block construction	Occupancy:	Immediate
Air Conditioning:	Fully air conditioned	Lease Rate:	\$8.95 psf NNN
Parking:	72 parking spaces	Location:	Located on Route 1 approx. 1 mile off I-95
Column Spacing:	34' x 43'		

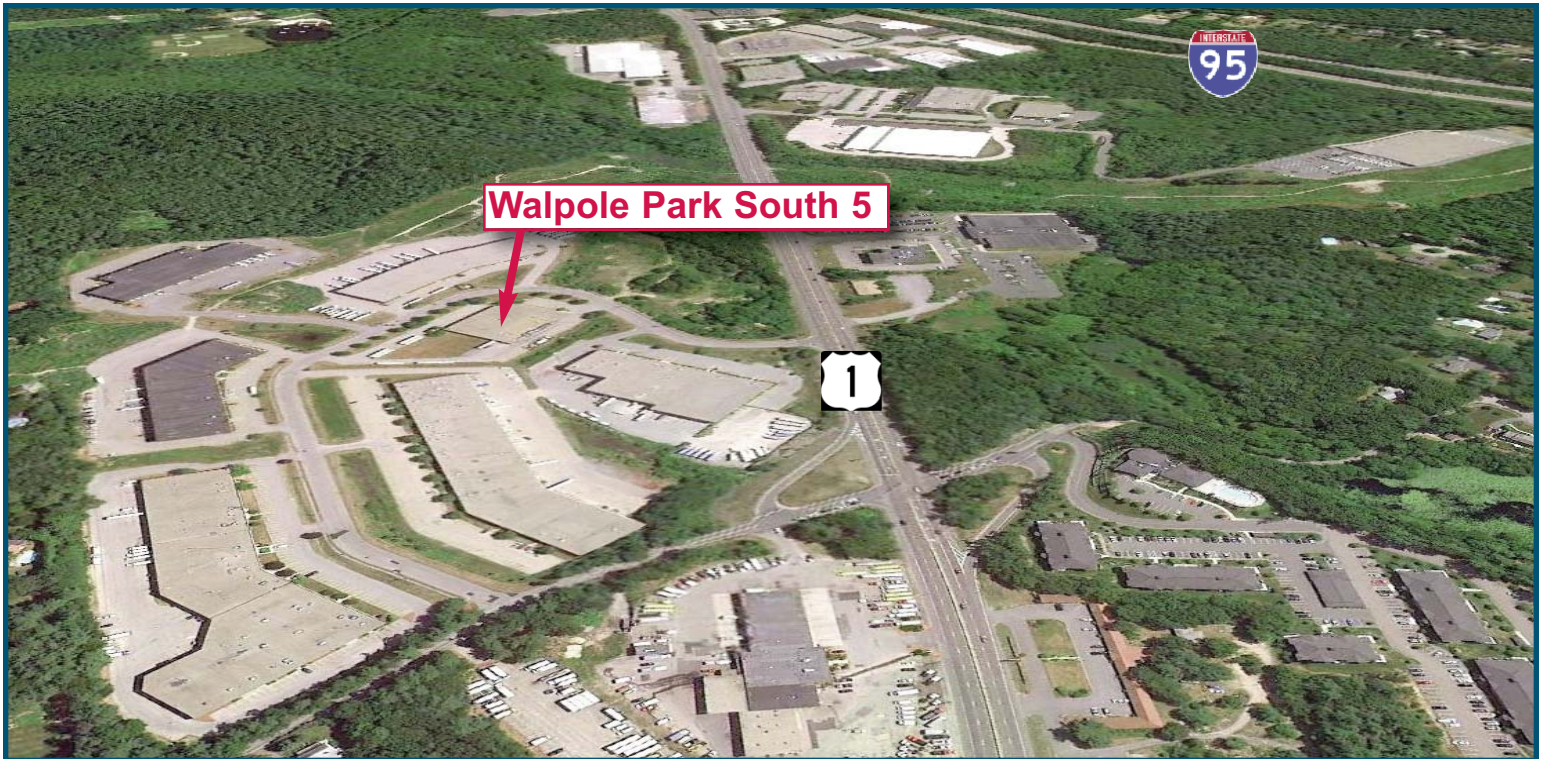

# WALPOLE PARK SOUTH | WALPOLE

18,990 SF with ±10,000 SF Expansion Capability  
Available For Lease

## FLOOR PLAN

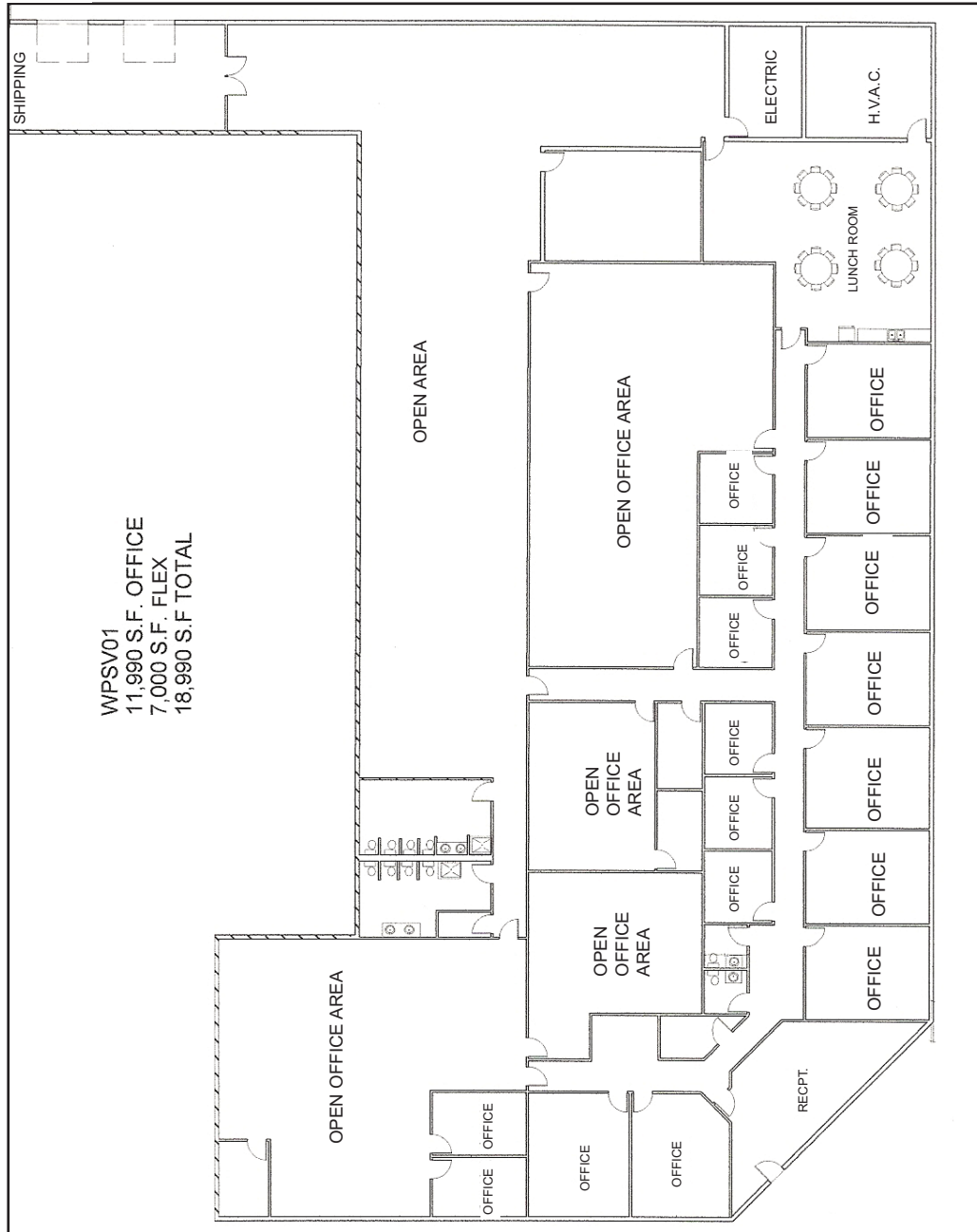

# WALPOLE PARK SOUTH | WALPOLE

## Office/Flex Building for Lease

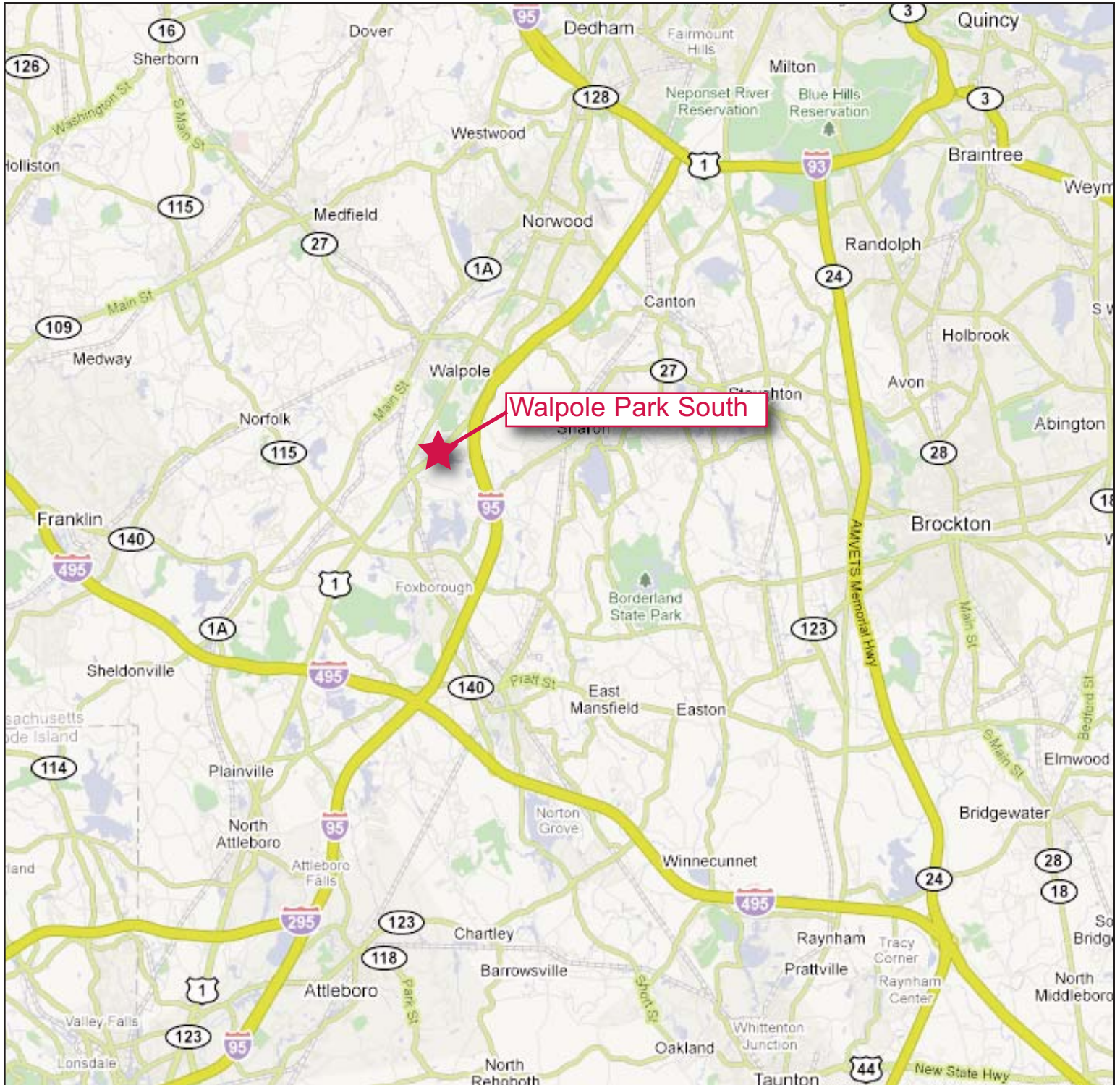

### contact information



Commercial Real Estate Services, Worldwide.

All information furnished regarding property for sale or lease is from sources deemed reliable, but no warranty or representation is made as to the accuracy thereof and same is submitted subject to errors, omissions, change of price, rental or other conditions prior to sale or lease, or withdrawal without notice.

Cathy Minnerly, Executive Vice President | 617 457 3334 | [cminnerly@naihunneman.com](mailto:cminnerly@naihunneman.com)

Ovar Osvold, Associate | 617 457 3222 | [osvold@naihunneman.com](mailto:osvold@naihunneman.com)

303 Congress Street | Boston, MA 02210 | 617 457 3400 | [www.naihunneman.com](http://www.naihunneman.com)