

OFFICE SPACE FOR LEASE

810 Memorial Drive | Cambridge

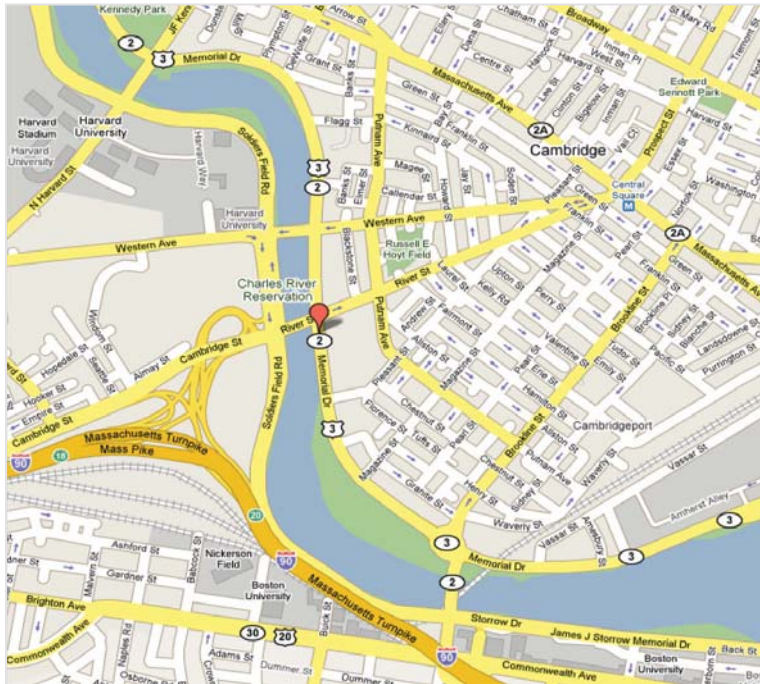

Finished Office Suites Will Divide!



Location	At the corner of Memorial Drive and River Street, Cambridge.
Building	32,850 SF of office space on 3 levels with high-rise apartments.
Available Space	Mezzanine: 569-2,045 RSF. - 742 sf, 734 sf, 569 sf or a total of 2,045 sf - Fully built out, vacant and ready to occupy now. - Suite has access to kitchen and shower facilities
Asking Rate	\$25.00/RSF gross (plus tenant electricity)
Parking	1 garage space per 1,000 SF FREE. Another 1/1,000 SF at \$170/month/space.
Public Transportation	Zipcar service onsite (www.zipcar.com), #64 bus to Central Square MBTA Red Line.
Amenities	Charles River views, Whole Foods and Rite Aid next door, Doubletree Guest Suites Hotel with Boathouse Grille, River Gods Café, Starbucks, Trader Joe's, and Micro Center nearby.

2 Spaces/1,000 SF in our Parking Garage and Whole Foods Market Next Door



Commercial Real Estate Services, Worldwide.

All information furnished regarding property for sale or lease is from sources deemed reliable, but no warranty or representation is made as to the accuracy thereof and same is submitted subject to errors, omissions, change of price, rental or other conditions prior to sale or lease, or withdrawal without notice.

303 Congress Street | Boston, MA 02210 | 617 457 3400 | www.naihunneman.com

contact information

Greg Larsen, SVP | 617 457 3321 | glarsen@naihunneman.com

810 MEMORIAL DRIVE | CAMBRIDGE

Office Space for Lease

Mezzanine Plan (available space is outlined)

742 SF
734 SF
569 SF
2,045 SF

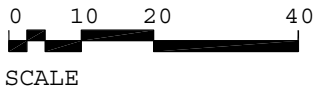
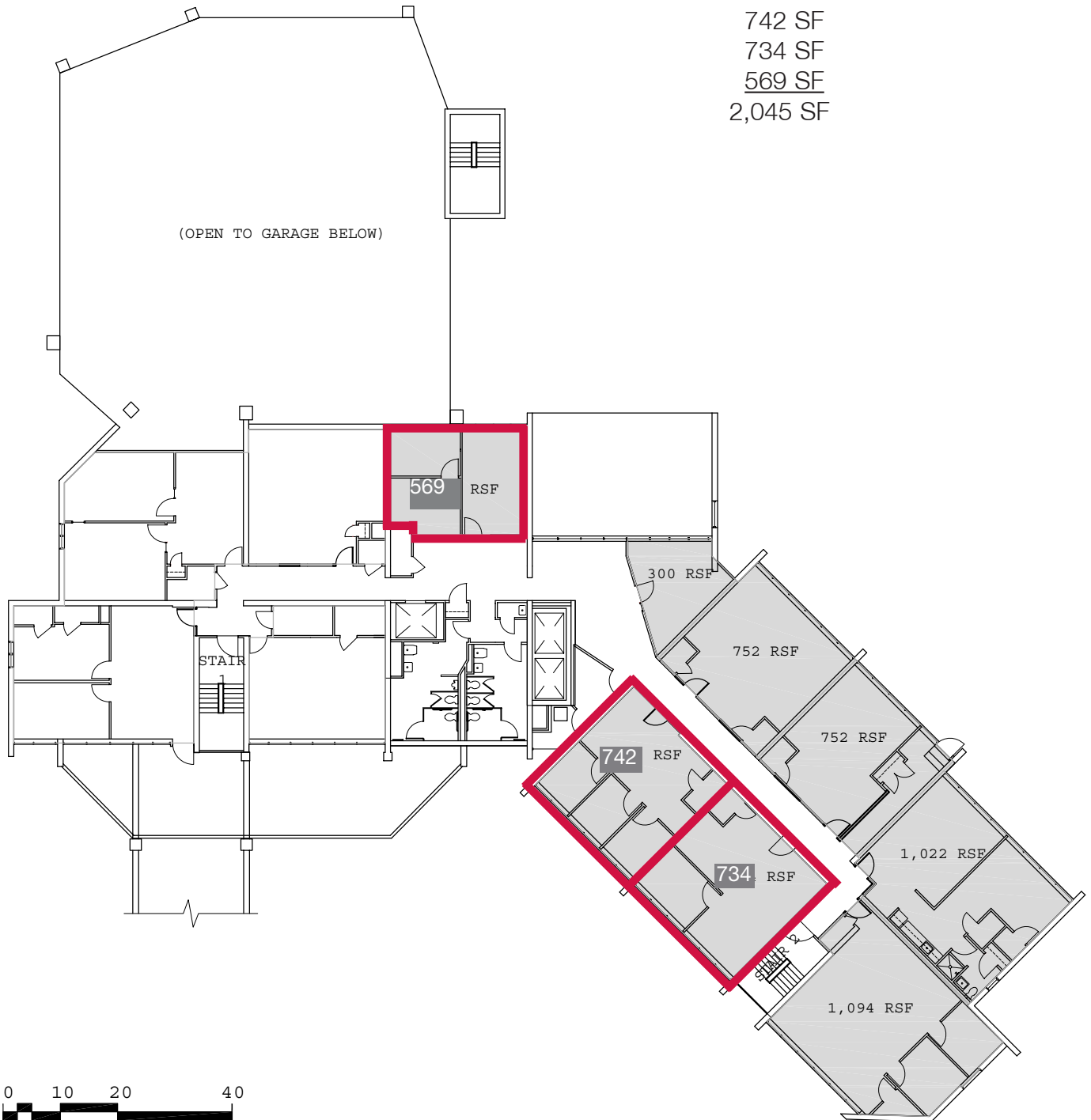

contact information

Greg Larsen, SVP | 617 457 3321 | glarsen@naihunneman.com

NAIHunneman

Commercial Real Estate Services, Worldwide.

303 Congress Street | Boston, MA 02210 | 617 457 3400 | www.naihunneman.com

All information furnished regarding property for sale or lease is from sources deemed reliable, but no warranty or representation is made as to the accuracy thereof and same is submitted subject to errors, omissions, change of price, rental or other conditions prior to sale or lease, or withdrawal without notice.