

FOR SUBLEASE

554 Clark Road | Tewksbury, MA



BUILDING SPECIFICATIONS

Total Area:	102,200 SF
Available Space:	102,200 RSF (subdividable)
Subdivides to:	30,000 RSF
Land Area:	10.54 Acres
Construction:	1985
Building Uses:	Office/R&D/Light Manufacturing
Construction:	Block & Steel
Clear Height:	15'
Utilities:	Full A/C Gas Heating Sewer City Water
Elevator:	1
Loading:	1-5 ext docks
Building Power:	480 Volts
Zoning:	I, Tewksbury
Parking:	2.64/1,000 RSF
Lease Expiration:	05/16/2017

30,000-102,200 RSF AVAILABLE
MULTIPLE SUBDIVISION OPTIONS

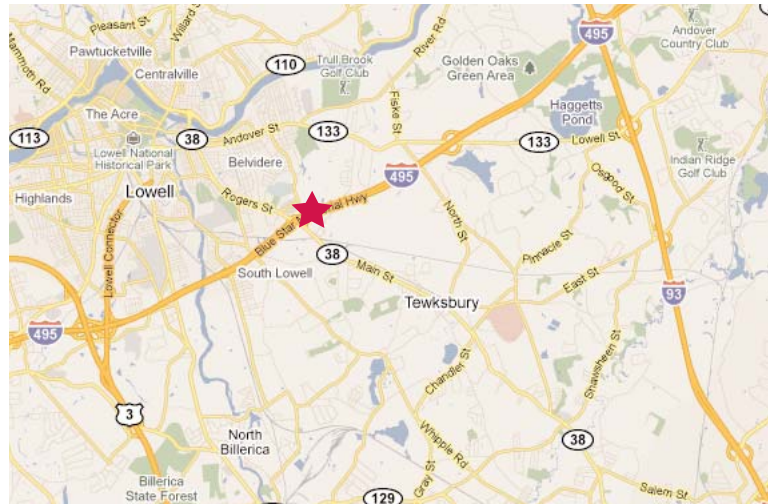

contact information



Commercial Real Estate Services, Worldwide.

All information furnished regarding property for sale or lease is from sources deemed reliable, but no warranty or representation is made as to the accuracy thereof and same is submitted subject to errors, omissions, change of price, rental or other conditions prior to sale or lease, or withdrawal without notice.

David Gilkie, Senior Vice President | 617 457 3202 | dgilkie@naihunneman.com

303 Congress Street | Boston, MA 02210 | 617 457 3400 | www.naihunneman.com

554 CLARK ROAD | TEWKSBURY, MA

Ideally located

Floor Plan

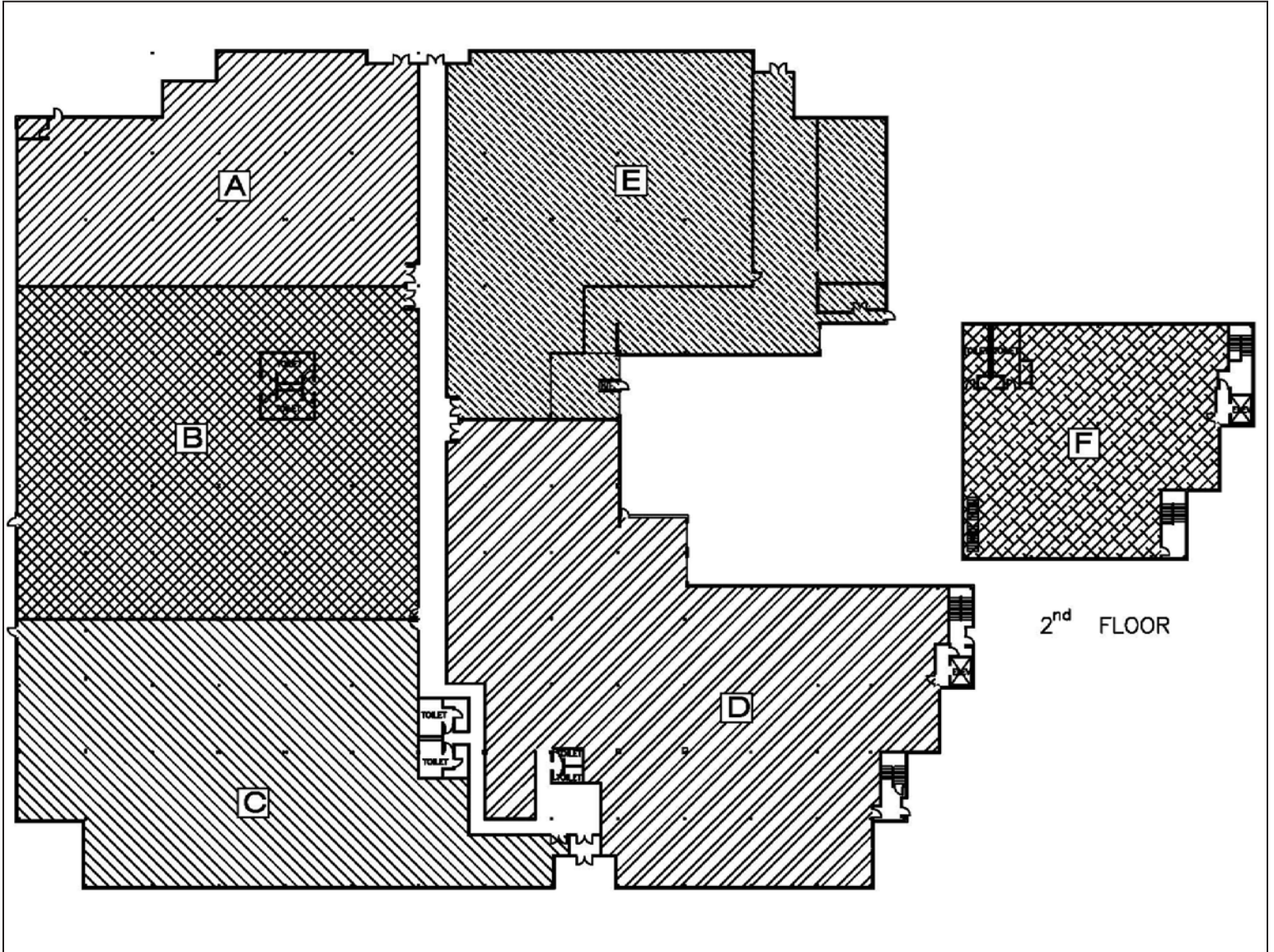

- A = 11,470 SF
- B = 18,650 SF
- C = 15,855 SF
- D = 21,394 SF
- E = 18,864 SF
- F = 7,853 SF

contact information



Commercial Real Estate Services, Worldwide.

David Gilkie, Senior Vice President | 617 457 3202 | dgilkie@naihunneman.com

303 Congress Street | Boston, MA 02210 | 617 457 3400 | www.naihunneman.com

All information furnished regarding property for sale or lease is from sources deemed reliable, but no warranty or representation is made as to the accuracy thereof and same is submitted subject to errors, omissions, change of price, rental or other conditions prior to sale or lease, or withdrawal without notice.