

OFFICE SPACE FOR SUBLEASE

420 Boylston Street | Boston, MA



Great Open Space, Great Location

The Berkeley at 420 Boylston Street

Building Size: 114,668 SF on 6 floors

Typical Floor Size: 16,166 SF

Available Space: 3,927-7,353 RSF on the 3rd Floor

Asking Rate: Negotiable

Availability: Immediate

Term: 1-2 years

Amenities:

- Immediate access to the area's best restaurants, hotels, and shops.
- 24-hour manned security.
- Steps from Green Line T Station at Arlington Street, and walking distance from Orange Line T and MBTA Commuter Rail at Back Bay Station.
- Easy access to Mass Pike and Storrow Drive.
- Short walk to Boston Common & Public Gardens.

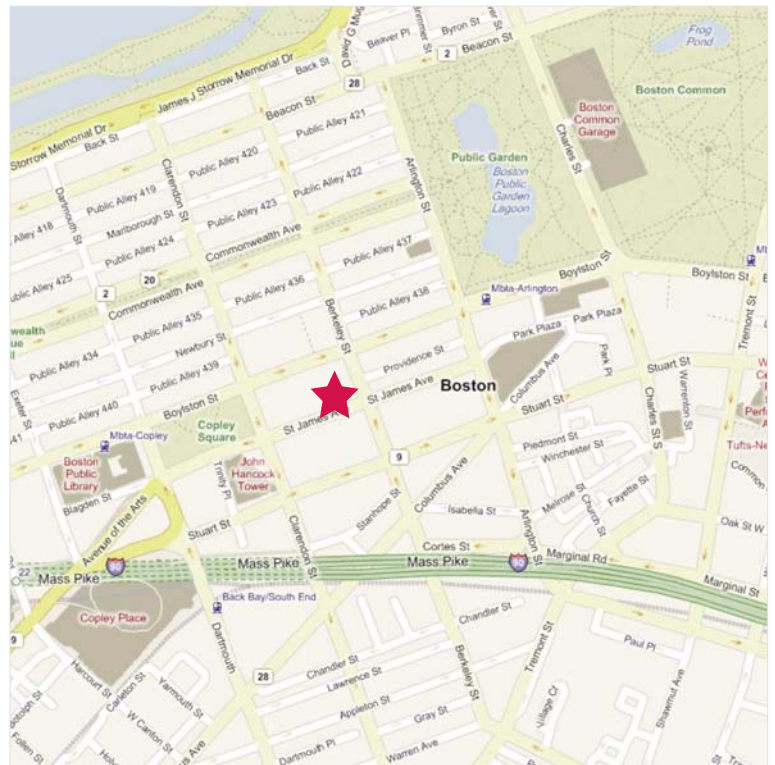

Commercial Real Estate Services, Worldwide.

All information furnished regarding property for sale or lease is from sources deemed reliable, but no warranty or representation is made as to the accuracy thereof and same is submitted subject to errors, omissions, change of price, rental or other conditions prior to sale or lease, or withdrawal without notice.

Jonathan H. Gifford, Senior Vice President | 617 457 3401 | jgifford@naihunneman.com

David M. Cooney, Vice President | 617 457 3305 | dcooney@naihunneman.com

303 Congress Street | Boston, MA 02210 | 617 457 3400 | www.naihunneman.com

contact information

THE BERKELEY AT 420 BOYLSTON

3,927-7,353 RSF of Office Space Available



3rd Floor Plan

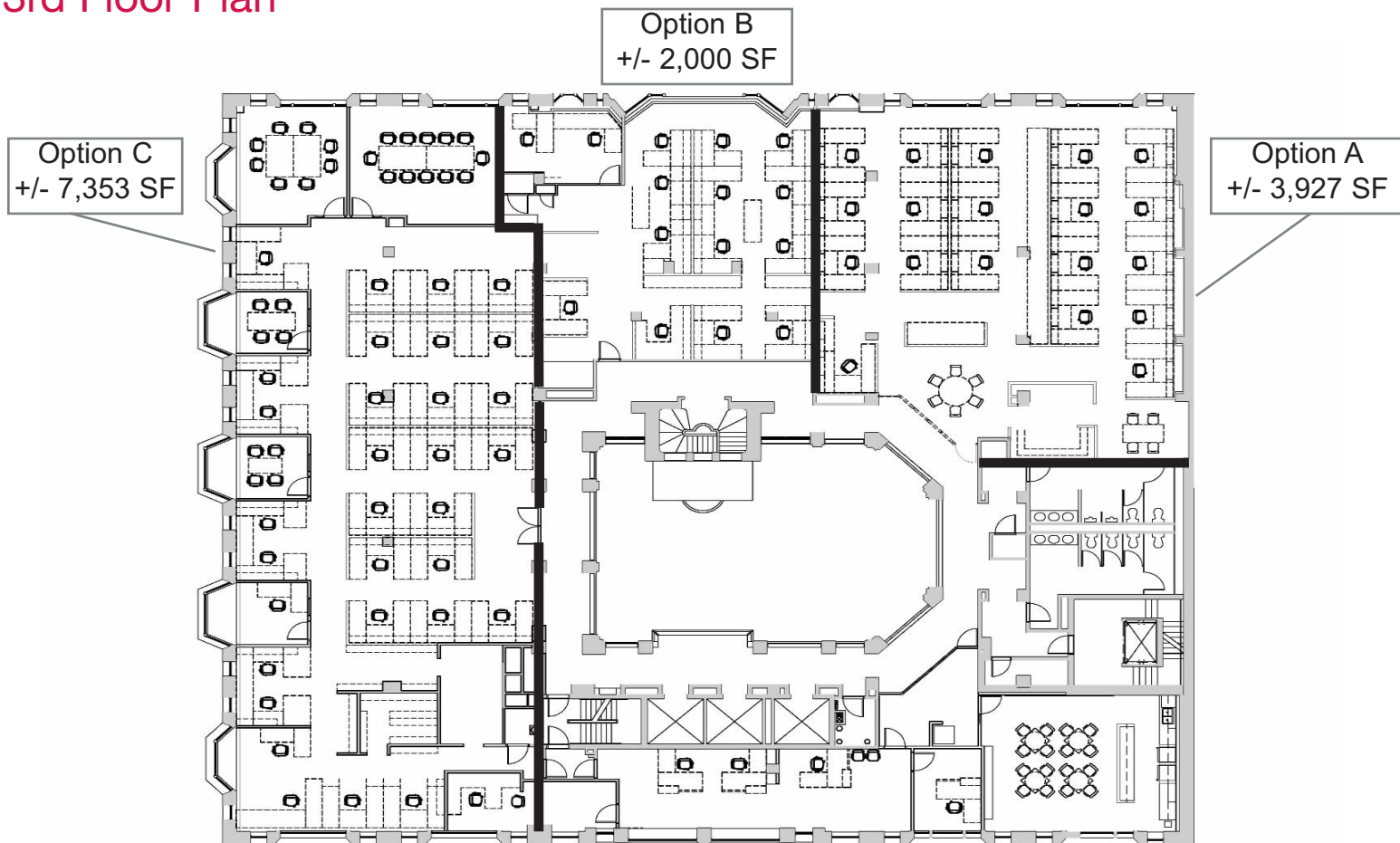

Commercial Real Estate Services, Worldwide.

All information furnished regarding property for sale or lease is from sources deemed reliable, but no warranty or representation is made as to the accuracy thereof and same is submitted subject to errors, omissions, change of price, rental or other conditions prior to sale or lease, or withdrawal without notice.

contact information

Jonathan H. Gifford, Senior Vice President | 617 457 3401 | jgifford@naihunneman.com

David M. Cooney, Vice President | 617 457 3305 | dcooney@naihunneman.com

303 Congress Street | Boston, MA 02210 | 617 457 3400 | www.naihunneman.com