

348 TURNPIKE ST | CANTON, MA



For Lease
3,000 SF up to 38,000 SF
Showroom/Office/Warehouse Building

contact information

NAIHunneman

Commercial Real Estate Services, Worldwide.

All information furnished regarding property for sale or lease is from sources deemed reliable, but no warranty or representation is made as to the accuracy thereof and same is submitted subject to errors, omissions, change of price, rental or other conditions prior to sale or lease, or withdrawal without notice.

Cathy Minnerly, Executive Vice President | 617 457 3334 | cminnerly@naihunneman.com

Ovar Osvold, Associate | 617 457 3222 | oosvold@naihunneman.com

303 Congress Street | Boston, MA 02210 | 617 457 3400 | www.naihunneman.com

348 TURNPIKE ST | CANTON

3,000 SF up to 38,000 SF

Showroom/Office/Warehouse Building



BUILDING SPECIFICATIONS:

Total SF	38,000 SF	Ceiling Clear Height	18' clear
Tenant A:	7,582 SF	Construction	Masonry
Office:	1,723 SF	Roof	Rubber Membrane
Warehouse:	5,859 SF	Sprinklers	Wet System
Tenant B:	10,360 SF	HVAC	Office area only
Office:	1,282 SF	Loading	4 tailboard loading docks
Warehouse:	9,078 SF	Zoning	I, Canton
Tenant C:	7,085 SF	Parking	Extensive parking available
Office:	1,826 SF	Utilities	Gas: Bay State Gas
Warehouse:	5,259 SF		Electric: NStar
Tenant D:	12,966 SF		Water: Town of Canton
			Sewer: Town of Canton
Available SF	3,000 SF up to 38,000 SF	R.E. Tax & CAM	\$1.00 psf / \$0.50 psf
Office	± 3,000 SF up to 13,000 SF	Available	Immediate
Warehouse	5,000 SF up to 25,000 SF	Lease Rate	TBD
Property Type	Showroom/Office/Warehouse	Location	Located on Route 138, 1.6 miles off Route 128/I-95
Land Area	2.5 Acres		
Year Built	1958		



348 TURNPIKE ST | CANTON

For Lease

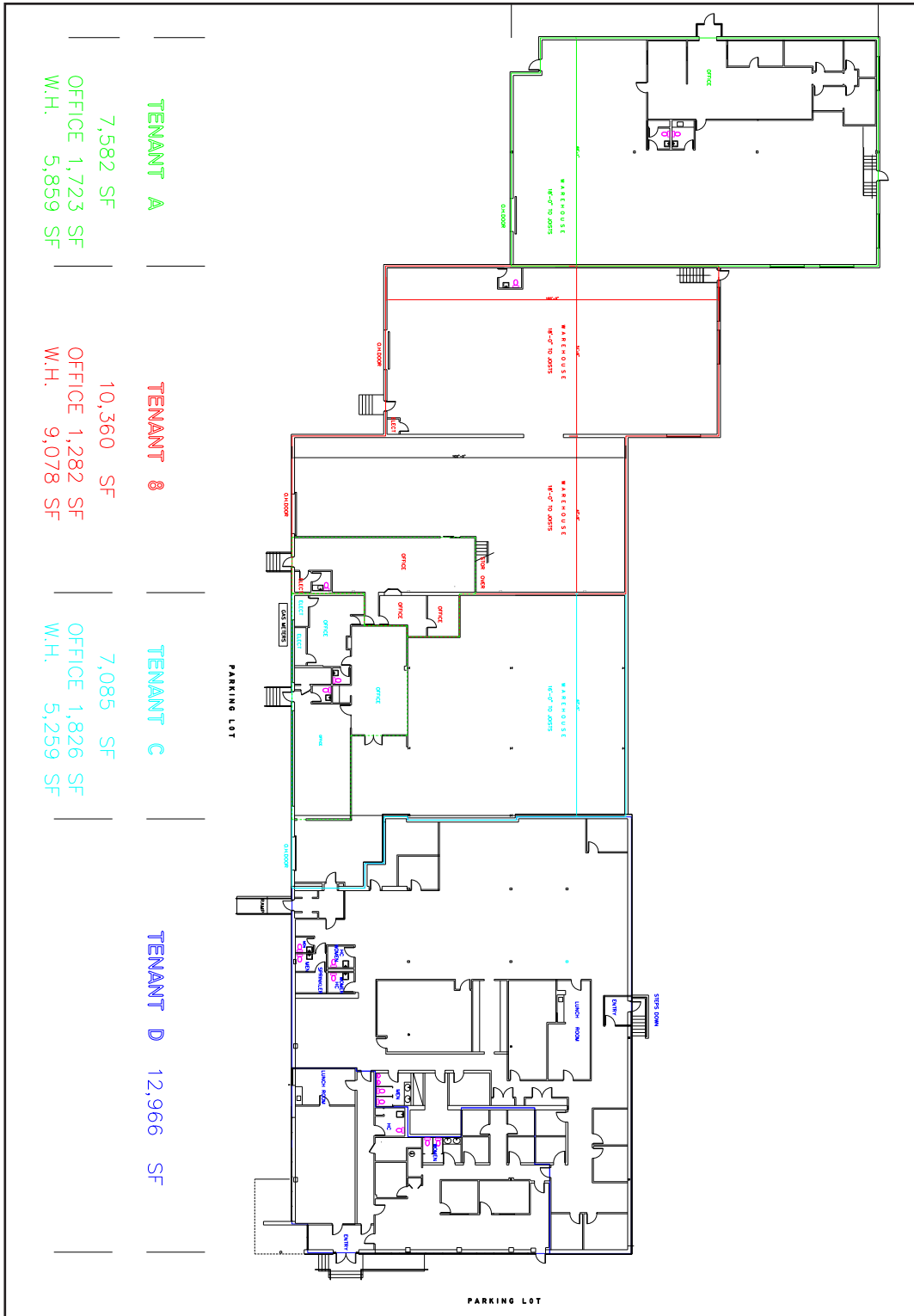

348 TURNPIKE ST | CANTON

3,000 SF up to 38,000 SF
Showroom/Office/Warehouse Building

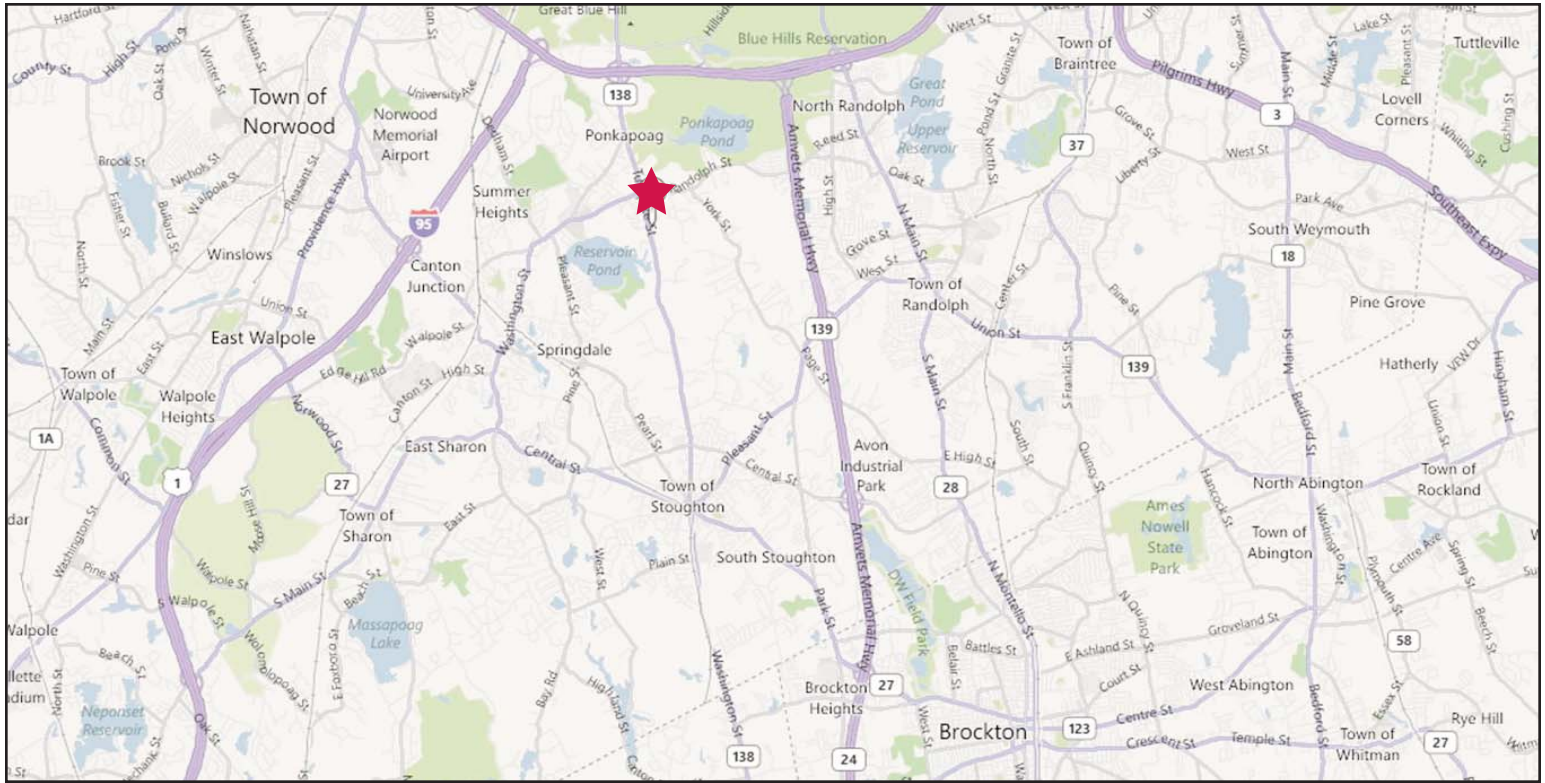

contact information

Cathy Minnerly, Executive Vice President | 617 457 3334 | cminnerly@naihunneman.com

Ovar Osvold, Associate | 617 457 3222 | osvold@naihunneman.com

303 Congress Street | Boston, MA 02210 | 617 457 3400 | www.naihunneman.com



Commercial Real Estate Services, Worldwide.

All information furnished regarding property for sale or lease is from sources deemed reliable, but no warranty or representation is made as to the accuracy thereof and same is submitted subject to errors, omissions, change of price, rental or other conditions prior to sale or lease, or withdrawal without notice.