

1245 PROVIDENCE HIGHWAY SHARON, MA Retail/Warehouse/Office Space for Lease



SPECIFICATIONS:

Total SF	45,000 SF	Roof	Recoated in 2010
Available SF	21,000 SF	Power	600 amps, 277/488 Volts
	<i>Warehouse:</i> 17,500 SF	Utilities	
	<i>Office:</i> 3,500 SF	Gas:	Bay State Gas
Available	Immediately	Electricity:	NStar
Year Built	1974, an addition in 1984	Water:	Town of Sharon
Clear Height	18' - 22'	Septic:	Private
Zoning	Light Industrial	Lease Rate	TBD
Loading	7 tailboards	R.E. Tax & CAM	\$0.75/SF & \$0.70/SF \$1.45/SF total
Column Spacing	25' x 60'	Traffic Count	±30,000 cars per day
Parking	45 spaces	Location	On Route 1, approximately 1 mile off I-95

contact information



Commercial Real Estate Services, Worldwide.

All information furnished regarding property for sale or lease is from sources deemed reliable, but no warranty or representation is made as to the accuracy thereof and same is submitted subject to errors, omissions, change of price, rental or other conditions prior to sale or lease, or withdrawal without notice.

Cathy Minnerly, Executive Vice President | 617 457 3334 | cminnerly@naihunneman.com

Ovar Osvold, Associate | 617 457 3222 | oosvold@naihunneman.com

303 Congress Street | Boston, MA 02210 | 617 457 3400 | www.naihunneman.com

1245 PROVIDENCE HIGHWAY | SHARON

21,000 SF for Lease

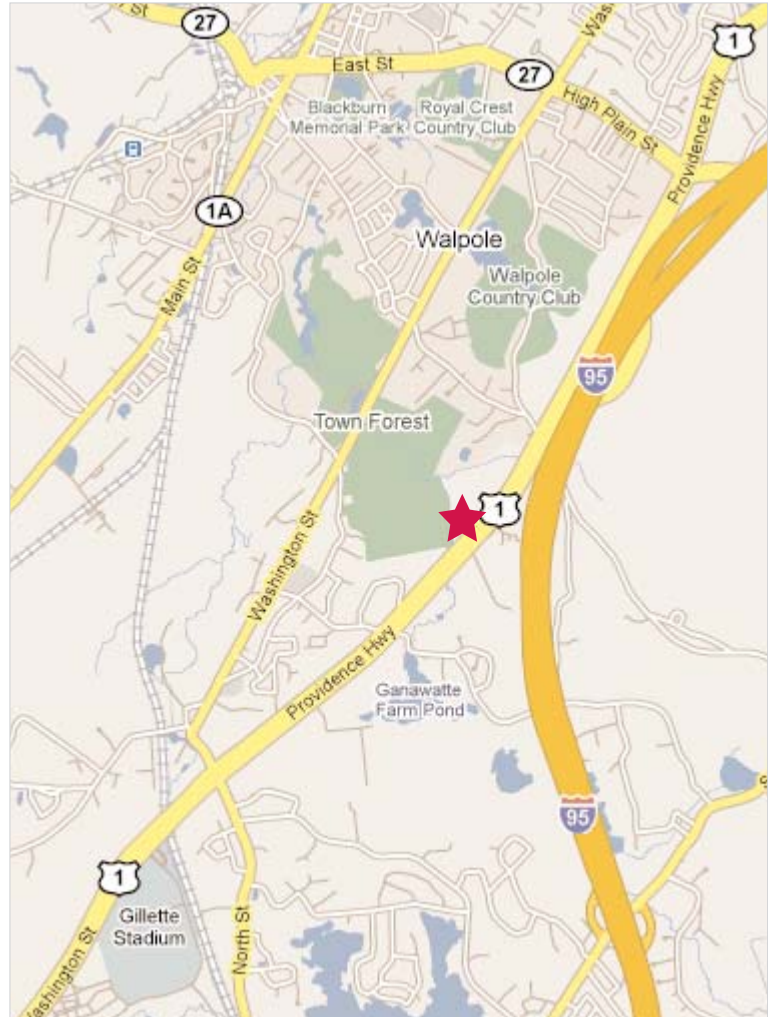
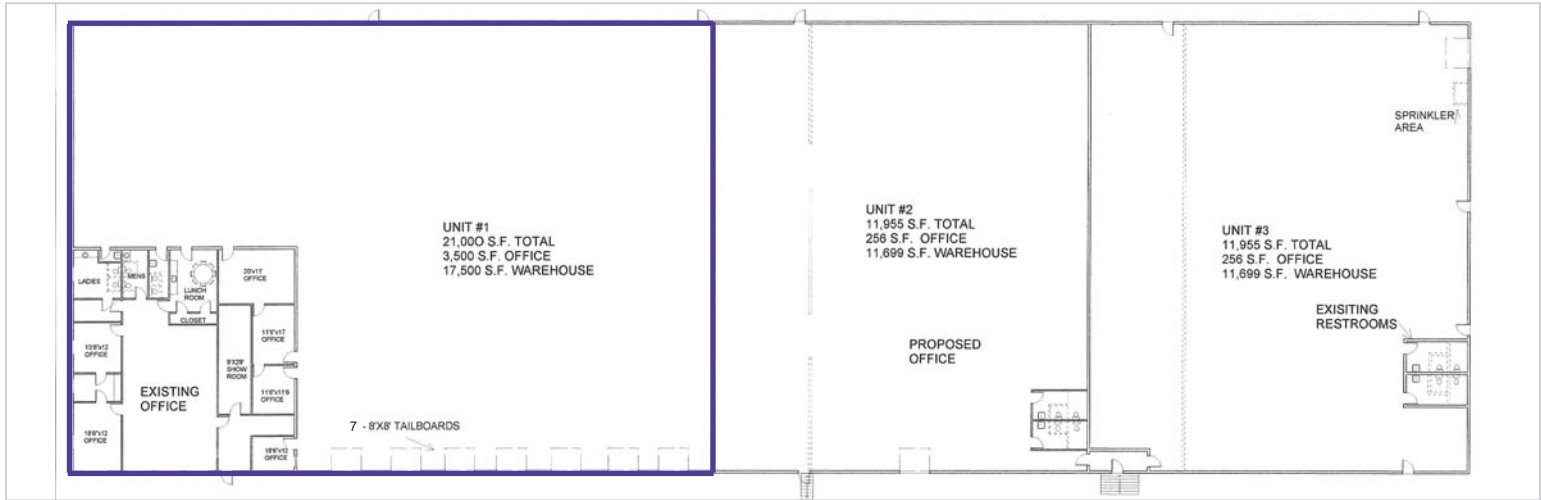

Commercial Real Estate Services, Worldwide.

All information furnished regarding property for sale or lease is from sources deemed reliable, but no warranty or representation is made as to the accuracy thereof and same is submitted subject to errors, omissions, change of price, rental or other conditions prior to sale or lease, or withdrawal without notice.

contact information

Cathy Minnerly, Executive Vice President | 617 457 3334 | cminnerly@naihunneman.com

Ovar Osvold, Associate | 617 457 3222 | oosvold@naihunneman.com

303 Congress Street | Boston, MA 02210 | 617 457 3400 | www.naihunneman.com