

100 Research Drive

Wilmington, MA

7,526 – 16,313 SF Available for Lease



Building Information

| | | | |
|------------------------|---|--------------------|----------------------------------|
| Available SF: | 16,313 | Power: | 1,200 amp; 480/277 volt, 3 phase |
| Parking: | 3.86 spaces per 1,000 sf | Sprinkler: | 100% wet sprinkler system |
| Zoning: | GI, Wilmington | Year Built: | 1986 |
| Ceiling Height: | 16' | Docks: | 2 tailboard loading docks |
| Roof: | EPDM Ballastad Rubber Membrane | HVAC: | Gas fired rooftop units |
| Utilities: | Electricity: Reading Municipal Light Water/Sewer: Town of Wilmington Gas: KeySpan | | |



For Further Information, Contact:

Dan Collins
Vice President
Direct: 617-457-3252
Cell: 617-918-3993
dcollins@naihunneman.com

Jim Boudrot
Senior Vice President
Direct: 617-457-3328
Cell: 617-957-1407
jboudrot@naihunneman.com

Mike McCarthy
Assistant Vice President
Direct: 617-457-3224
Cell: 781-883-8518
mmccarthy@naihunneman.com

NAI Hunneman
Commercial Real Estate Services, Worldwide.

All information furnished regarding property for sale or lease is from sources deemed reliable, but no warranty or representation is made as to the accuracy thereof and same is submitted subject to errors, omissions, change of price, rental or other conditions prior to sale or lease, or withdrawal without notice.

www.naihunneman.com

100 Research Drive

Wilmington, MA

Location

- 1 mile to Interstate 93
- 6 miles to Route 95/128 Interchange

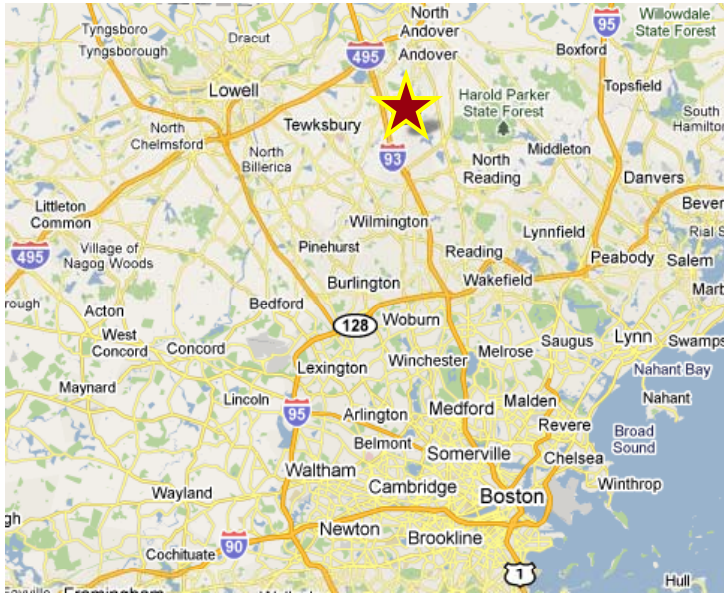

Floor Plan

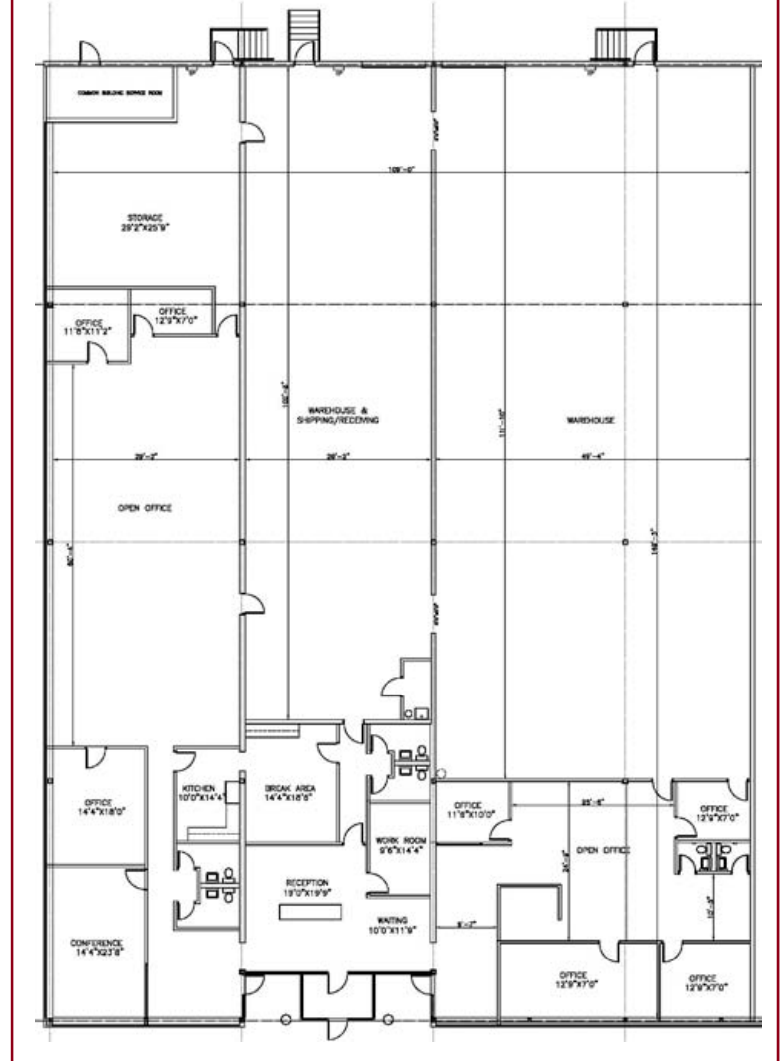

Not to scale. All dimensions are approximate.

NAI Hunneman

Commercial Real Estate Services, Worldwide.

For Further Information, Contact:

Dan Collins
Vice President
Direct: 617-457-3252
Cell: 617-918-3993
dcollins@naihunneman.com

Jim Boudrot
Senior Vice President
Direct: 617-457-3328
Cell: 617-957-1407
jboudrot@naihunneman.com

Mike McCarthy
Assistant Vice President
Direct: 617-457-3224
Cell: 781-883-8518
mmccarthy@naihunneman.com